

# \$240,000 - 716 2 Street E, Brooks

MLS® #A2206702

## \$240,000

2 Bedroom, 1.00 Bathroom, 935 sqft  
Residential on 0.36 Acres

Central, Brooks, Alberta

This large corner lot, centrally located in Brooks, AB has recently been re-zoned to Residential Medium Density. The current use of the property is a long term rental that generates steady income. The potential under the new zoning provides for great development opportunity for up to 8 units either for long term rentals or to sell off as permanent housing for new homeowners. With the ongoing need for more housing within our community this would be a valued project. The location being close to schools, shopping, the hospital and recreation centre is also an asset. Have a look today and GET MOVING IN THE RIGHT DIRECTION!

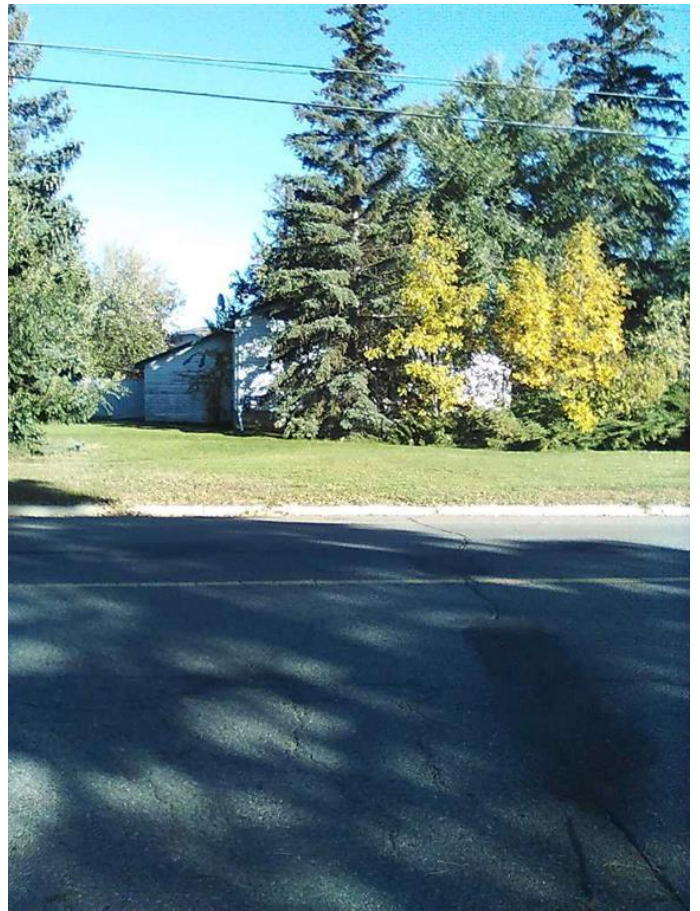

Built in 1946

## Essential Information

MLS® #	A2206702
Price	\$240,000
Bedrooms	2
Bathrooms	1.00
Full Baths	1
Square Footage	935
Acres	0.36
Year Built	1946
Type	Residential
Sub-Type	Detached
Style	Bi-Level
Status	Active

## Community Information

Address 716 2 Street E  
Subdivision Central  
City Brooks  
County Brooks  
Province Alberta  
Postal Code T1R 0M9

## Amenities

Parking Spaces 4  
Parking Off Street

## Interior

Interior Features See Remarks  
Appliances None  
Heating Forced Air  
Cooling None  
Has Basement Yes  
Basement Partial, Unfinished

## Exterior

Exterior Features None  
Lot Description Back Lane, Corner Lot  
Roof Asphalt Shingle  
Construction Wood Siding  
Foundation Poured Concrete

## Additional Information

Date Listed March 27th, 2025  
Days on Market 26  
Zoning R-MD

## Listing Details

Listing Office Harvest Real Estate



Data is supplied by Pillar 9â„¢ MLSÂ® System. Pillar 9â„¢ is the owner of the copyright in its MLSÂ® System. Data is deemed reliable but is not guaranteed accurate by Pillar 9â„¢. The trademarks MLSÂ®, Multiple Listing ServiceÂ® and the associated logos are owned by The Canadian Real Estate Association (CREA) and identify the quality of services provided by real estate professionals who are members of CREA. Used under license.